

IPS & DIPS

WATER-STOP / THRUST-ISOLATOR WALL-PIPE / ANCHOR RING

DIMENSIONAL TOLERANCES ARE $\pm 1"$
ANGULAR TOLERANCES ARE $\pm 2^\circ$
(DIMENSIONS IN INCHES)

This pipeline component serves to restrain and anchor against thermal expansion and contraction as well as prevent "French" draining of water along the pipe OD. It is a multipurpose fitting used in several ways for different reasons - hence, several names for the same part. It is engineered to hold the pipe in place by transferring the thermal force from the pipe to the soil or vault wall via large area of usually reinforced concrete. Make sure the soil bearing load area, as well as the thickness and strength of the concrete is sufficient.

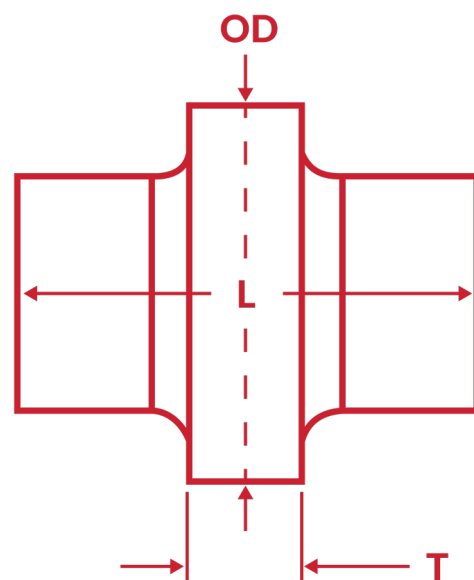

IPS & DIPS NOMINAL SIZE	L	OD	T	DR
2" IPS	12.0	3.50	2.00	ALL
3"	12.0	5.00	2.00	ALL
4"	12.0	6.60	2.00	ALL
6"	12.0	8.50	2.00	ALL
8"	16.0	10.63	2.00	ALL
10"	18.0	12.75	2.00	ALL
12"	22.0	15.00	2.00	ALL
14"	22.0	17.50	2.00	ALL
16"	24.0	20.00	2.00	ALL
18"	24.0	21.12	2.00	ALL
20"	24.0	23.50	2.00	ALL
22"	24.0	25.60	2.00	ALL
24"	28.0	28.00	2.00	ALL